



**CITY OF CALIMESA, CALIFORNIA**

## County Line Village

Come join this exciting new commercial retail center located on County Line Road in the City of Calimesa. A total of 20,000 square feet of retail commercial space available in this project. All pads are currently available and this site would make a great spot for restaurant and other small commercial retail uses. Buildings A and C are approximately 5,000 sf each, and Building B is approximately 10,000 sf.

Average Daily Traffic Counts: I-10 : 102,800

County Line Road: 15,670

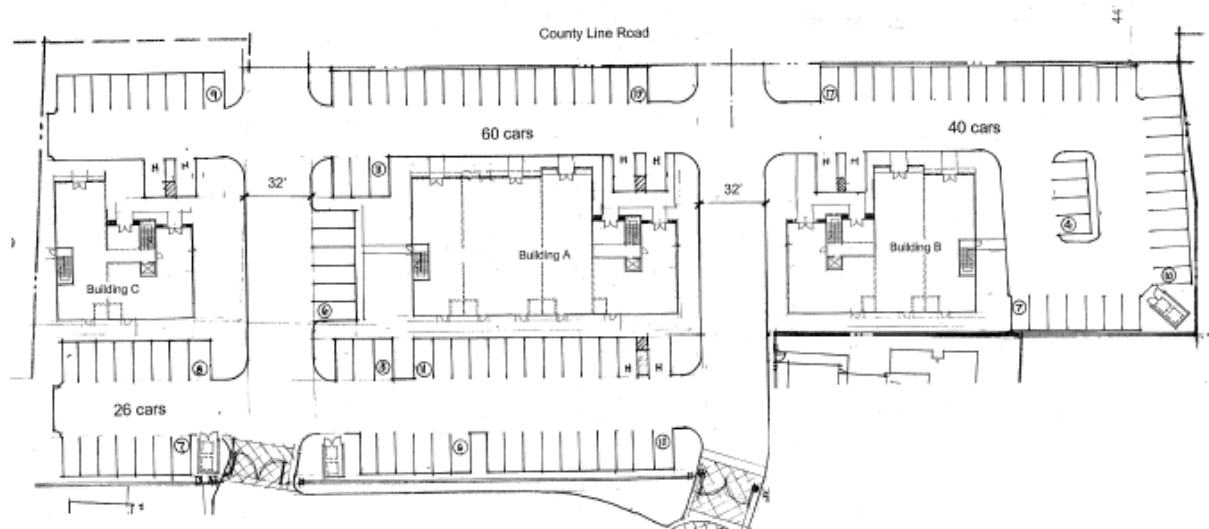

Calimesa is located approximately 75 miles east of Los Angeles and 30 miles west of Palm Springs in Riverside County. Ontario/Los Angeles International Airport is located approximately 30 miles east of Calimesa.

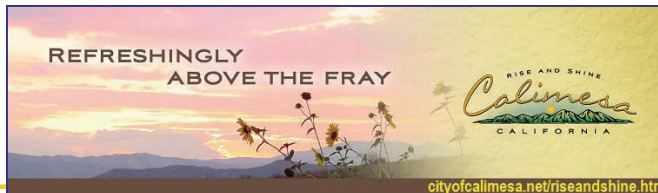

**SEE BACK OF PAGE FOR  
DEMOGRAPHIC  
INFORMATION**

City of Calimesa  
908 Park Avenue  
Calimesa, CA 92320  
[www.cityofcalimesa.net/riseandshine.htm](http://www.cityofcalimesa.net/riseandshine.htm)

Randy Anstine, City Manager  
[ranstine@cityofcalimesa.net](mailto:ranstine@cityofcalimesa.net)  
Phone: 909.795.9801  
Fax: 909.795.6187